

Sprocket Type	Code Number	Number of Teeth	Bore	Pitch Diameter	Outside Diameter	Hub Width
			B	E	F/D	A
			mm/inch	mm	mm	mm

**Split Sprockets And Idlers, Machined - SS/SI 661 continued**

Idlers, Inch Bores						
KUS 661 11-1 1/4"	753.95.10	11	1.250"	90.2	89.9	40
KUS 661 11-1 7/16"	753.95.11	11	1.438"			
KUS 661 11-1 1/2"	753.95.12	11	1.500"			
KUS 661 13-1 1/4"	753.95.23	13	1.250"	106.1	106.7	
KUS 661 13-1 7/16"	753.95.24	13	1.438"			
KUS 661 13-1 1/2"	753.95.25	13	1.500"			
KUS 661 14-1 1/4"	753.95.36	14	1.250"	114.1	114.6	
KUS 661 14-1 7/16"	753.95.37	14	1.438"			
KUS 661 14-1 1/2"	753.95.38	14	1.500"			
KUS 661 15-1 1/4"	753.95.49	15	1.250"	122.2	122.8	
KUS 661 15-1 7/16"	753.95.50	15	1.438"			
KUS 661 15-1 1/2"	753.95.51	15	1.500"			
KUS 661 16-1 1/4"	753.95.62	16	1.250"	130.2	131.0	
KUS 661 16-1 7/16"	753.95.63	16	1.438"			
KUS 661 16-1 1/2"	753.95.64	16	1.500"			
KUS 661 19-1 1/4"	753.95.75	19	1.250"	154.3	155.4	
KUS 661 19-1 7/16"	753.95.76	19	1.438"			
KUS 661 19-1 1/2"	753.95.77	19	1.500"			

**NS 831**

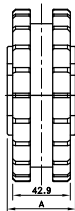
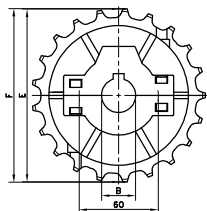

**NSH 820/831**

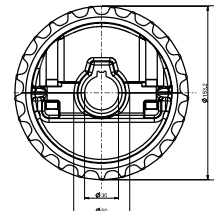

Sprocket Type	Code Number	Number of Teeth	Bore	Pitch Diameter	Outside Diameter	Width (Teeth)	Hub Width	Hub Diameter
			B	E	F	C	A	
			mm/inch	mm	mm	mm	mm	mm

**Split Sprockets, Injection Moulded - NS 831**

Metric Bores								
NS831 21-25	L0831604102	21	25	129.3	129.5	42.9	51.0	60
NS831 21-30	L0831604112	21	30					
NS831 21-35	L0831604122	21	35					
NS831 21-40	L0831604132	21	40					
NS831 21-45	L0831604142	21	45					
NS831 23-25	L0831604152	23	25	141.2	142.0			
NS831 23-30	L0831604162	23	30					
NS831 23-35	L0831604172	23	35					
NS831 23-40	L0831604182	23	40					
NS831 23-45	L0831604192	23	45	153.2	154.2		58.5	
NS831 25-25	L0831604202	25	25					
NS831 25-30	L0831604212	25	30					
NS831 25-35	L0831604222	25	35					
NS831 25-40	L0831604232	25	40					
NS831 25-45	L0831604242	25	45					
Inch Bores								
NS831 21-1	L0831604252	21	1.000"	129.26	129.5	42.9	51.0	60
NS831 25-1	L0831604312	25	1.000"	153.21	154.2	42.9	58.5	

For plastic chain series: 820, 831, SH, SHD

\* Ask Customer service for minimum order quantity of sprockets with inch bores.

**Split Sprockets, Injection Moulded - NSH 820/831**

Metric Bores								
NSH820/831 25-25	L0820641083	25	25	153.2	154.2	42.9	40	60
NSH820/831 25-30	L0820641093	25	30					
NSH820/831 25-35	L0820641103	25	35					
NSH820/831 25-40	L0820641113	25	40					
NSH820/831 25-45	L0820641123	25	45					

For plastic chain series: 820, 831, SH, SHD.