

CHAIN GUIDE PROFILES 平行墊片

■ 平型墊軌

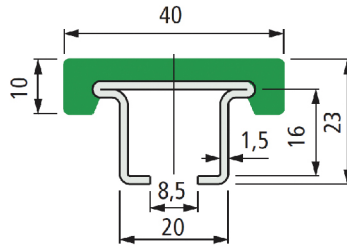

■ MIT-367 (19063VC) 3M,6M



Material:

- Plastic profile in UPE metal profile in AISI 304.

材質：

- 塑膠部份為UPE材質，金屬部份為304不鏽鋼

■ 螺絲固定座-單孔

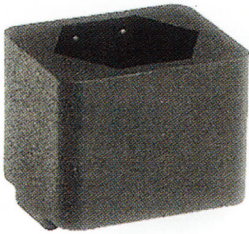

■ MIT-14109

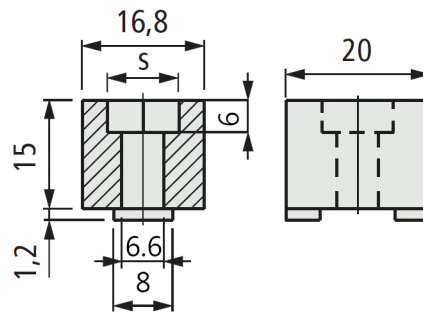

Material:

- Nylon
- Fixing with M8 hexagonal head bolt.

材質：

- 尼龍
- 固定M8六角螺絲

■ 螺絲固定座-雙孔

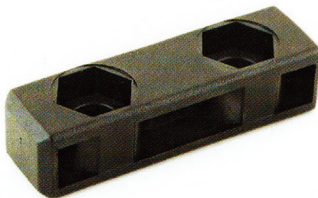

■ MIT-14111

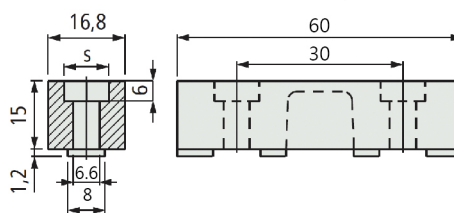

Material:

- Nylon
- Fixing with M8 hexagonal head bolt.

材質：

- 尼龍
- 固定M8六角螺絲

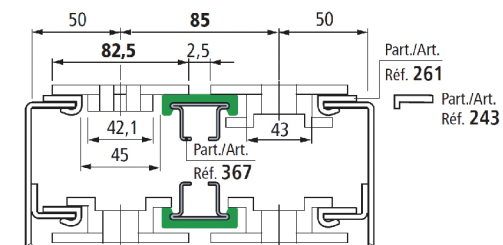
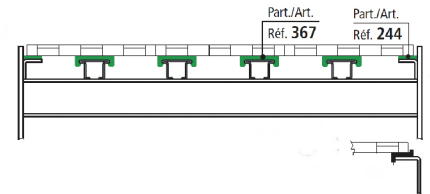
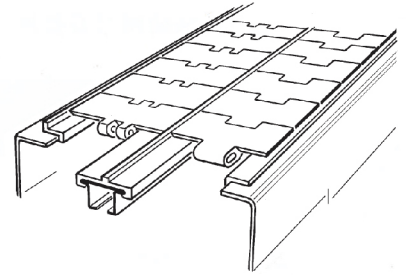

Chain guide profiles:

- Very low friction coefficient.
- High resistance to chemical agents.
- No liquid absorption.
- Quick assembly; easy to install.
- The plastic profile can slide along the metal profile, thus the heat makes expansion and the cold causes contraction.

特性：

- 超低摩擦係數
- 高酸鹼抗度
- 不吸水或其他液體
- 容易安裝
- 墊片隨著機架延伸，因此吸收了熱脹冷縮的差異